

1.17 2.30 1.68 1.35 1.65 1.35 1.63 1.36 1.65 1.35 1.67 1.34 1.66

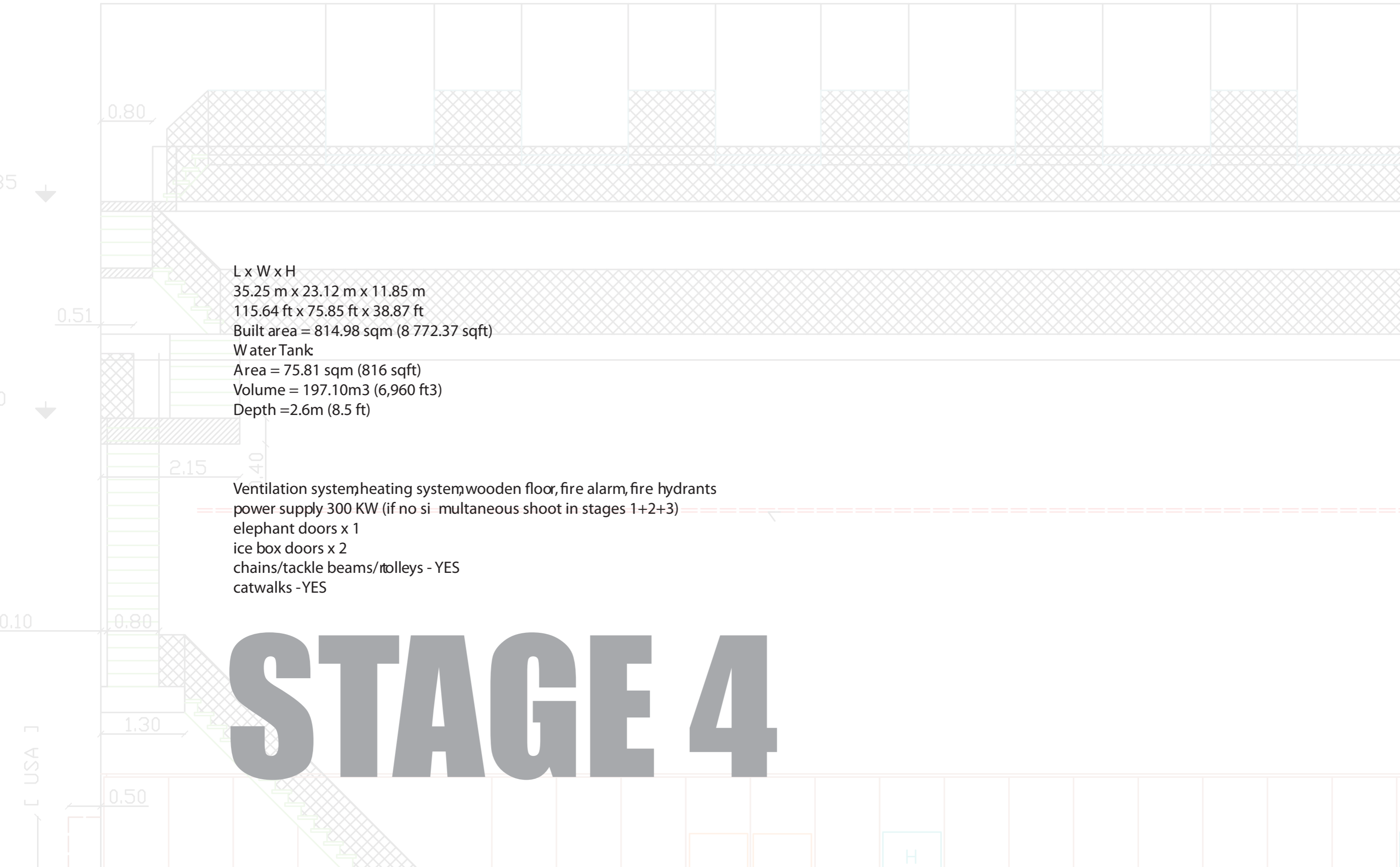

L x W x H  
35.25 m x 23.12 m x 11.85 m  
115.64 ft x 75.85 ft x 38.87 ft  
Built area = 814.98 sqm (8 772.37 sqft)  
Water Tank  
Area = 75.81 sqm (816 sqft)  
Volume = 197.10m3 (6,960 ft3)  
Depth =2.6m (8.5 ft)

- Ventilation system, heating system, wooden floor, fire alarm, fire hydrants
- power supply 300 KW (if no simultaneous shoot in stages 1+2+3)
- elephant doors x 1
- ice box doors x 2
- chains/tackle beams/trolleys - YES
- catwalks - YES

# STAGE 4

[ USA ]



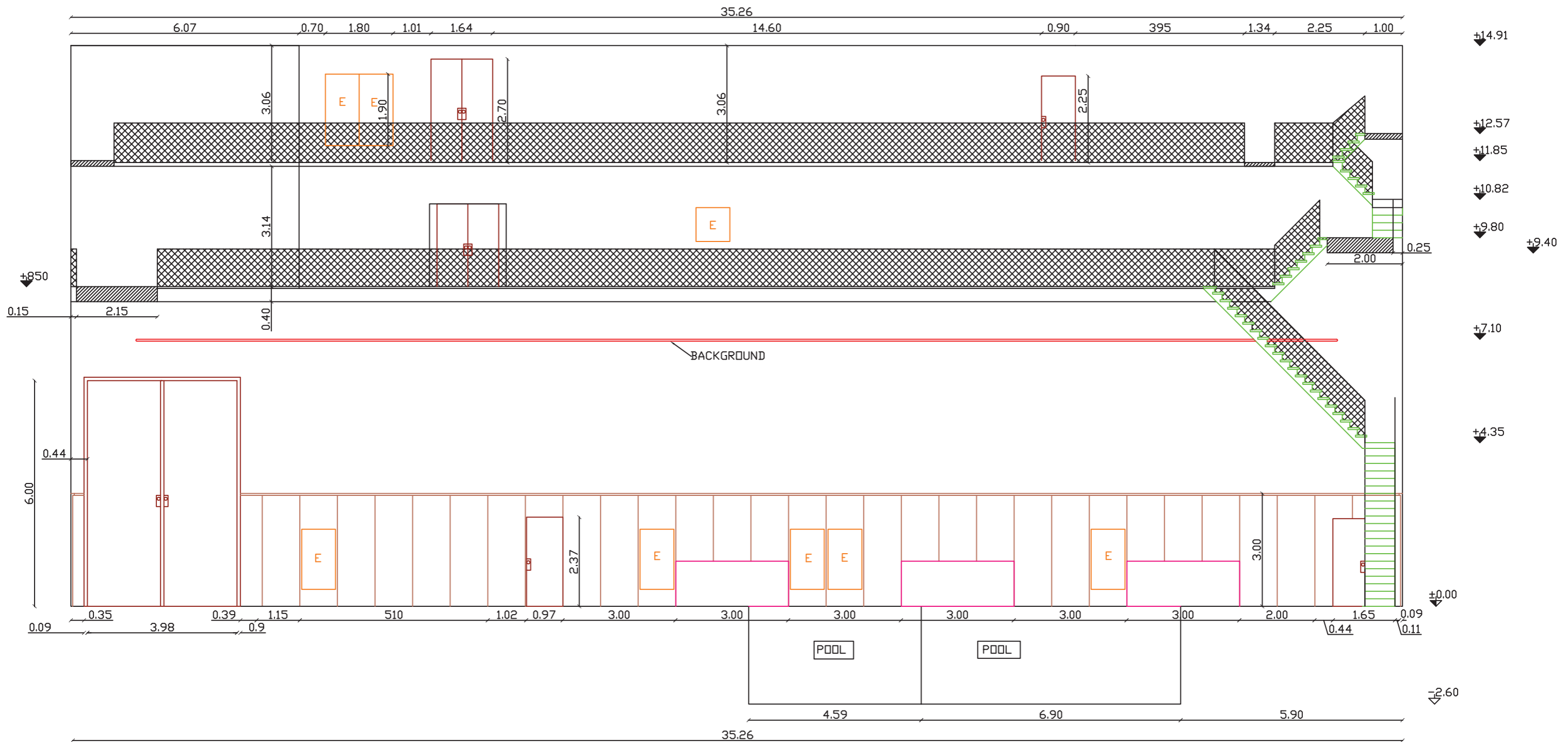

STAGE 4 LONGITUDINAL SECTION

LENGTH=35.25 M  
 WIDTH=23.12 M  
 HEIGHT=14.91 M  
 TOTAL AREA=35.25X23.12 =814.98 SQM  
 OPERABLE AREA=31.10X19.17 =596.18 SQM

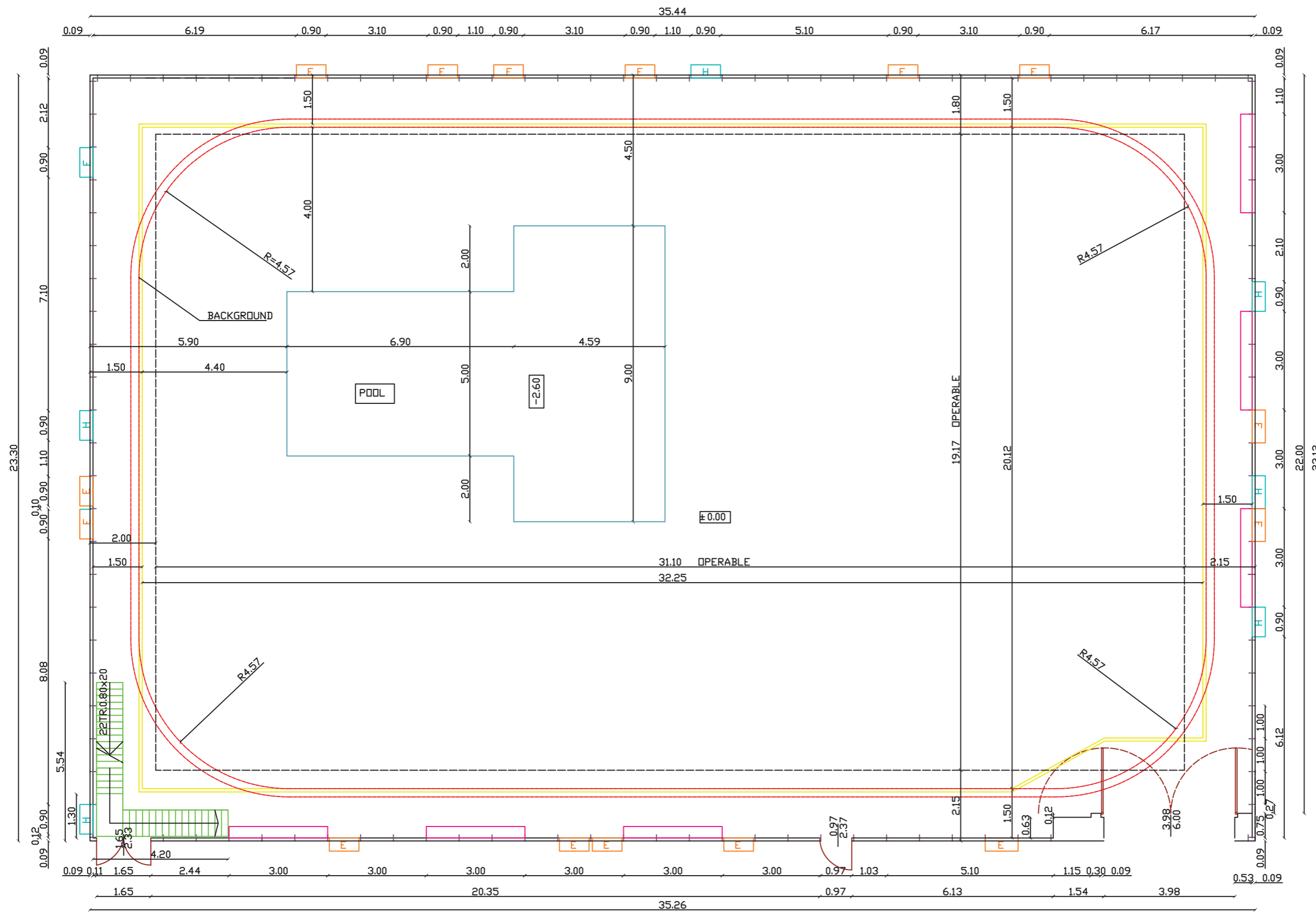

STAGE 4. PLAN SECTION +/- 0.00  
 LENGH=35.25 M  
 WIDTH=23.12 M  
 HEIGHT=14.91 M  
 TOTAL AREA=35.25X23.12 =814.98 SQM  
 OPERABLE AREA=31.10X19.17 =596.18 SQM



STAGE 4 PLAN

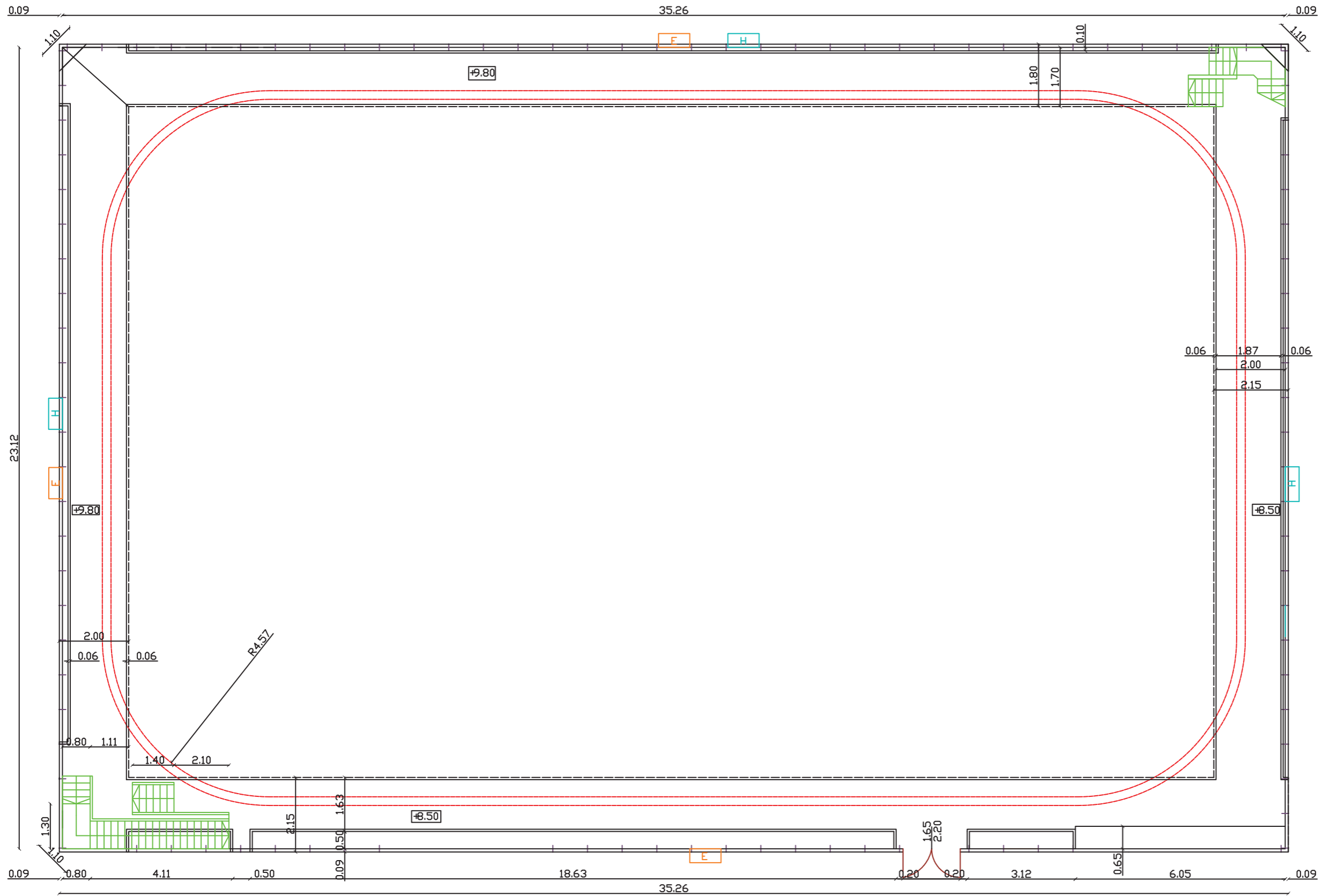

PLAN PLATDUL 4. COTA +8.50 / +9.50  
 STAGE 4. PLAN SECTION +/- 0.00  
 LENGTH=35.25 M  
 WIDTH=23.12 M  
 HEIGHT=14.91 M  
 TOTAL AREA=35.25X23.12 =814.98 SQM  
 OPERABLE AREA=31.10X19.17 =596.18 SQM

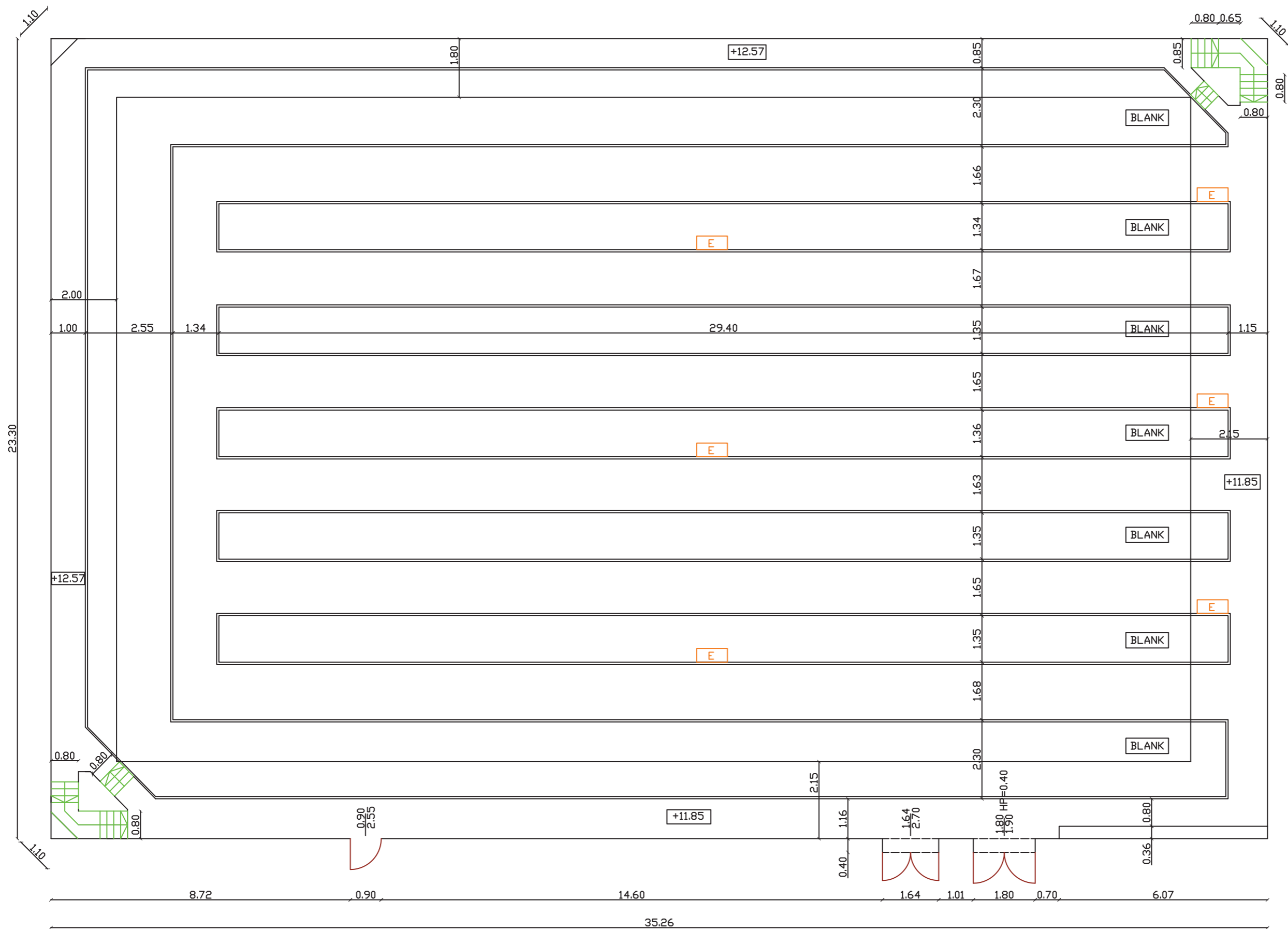

## STAGE 4 PLAN

STAGE 4. PLAN SECTION +11.85 / +12.57  
 LENGHT=35.25 M  
 WIDTH=23.12 M  
 HEIGHT=14.91 M  
 TOTAL AREA=35.25X23.12 =814.98 SQM  
 OPERABLE AREA=31.10X19.17 =596.18 SQM